

Diagonal Score Plate Envelopes

(note: finished envelope sizes are approximate)

Created by Jackie Topa

A2 Card

will fit card 5 ½" x 4 ¼"
cut paper 7 ¾" square
score @ 3-1/8" and 4-1/8"
finished size 5 ¾" x 4 ½"

Gift Card Envelope

will fit 2 ¼" x 3 ½" gift card
cut paper 4 ½" square
score @ 2-5/8" and 1-5/8"
finished size 3-5/8 x 2-1/4

Quarter Sheet Card

will fit card size 2 ¾" x 4 ¼"
cut paper 6" square
score @ 3-1/4" and 2-1/8"
finished size 4-1/2" x 3"

Love Note

will fit card size 5" x 3 ½"
cut paper 7" square
score @ 3-7/8" and 2-3/4"
finished size 4" x 5 ½"

Open End Envelope

fits card 3 ½" x 6 ½"
cut paper 7 ¾" square
score @ 4-7/8" and 2-1/2"
score one long side @ 5-1/8"
finished size 3 ¾" x 6 ¾"

3 x 6 Card

cut paper 7 ½" square
score @ 4-1/2" and 2-5/8"
finished size 3 ¾" x 6 ¼"

4 x 6 Card

cut paper 8" square
score @ 3-1/8" and 4-1/2"
score one long side @ 6-3/8"
finished size 4 ½" x 6 ¼"

Oversized A2 Card

will fit card 4 ½" x 5 ¾"
cut paper 8" square
score @ 3-3/8" x 4-1/4"
finished size 4 ¾" x 6"

Full Card

will fit card 5 ½" x 8 ½"
cut paper 11" square
score @ 4-1/4" and 6-1/4"
finished size 6" x 9"

Square Envelopes

2" Square Card

cut paper 4" square
score all sides @ 1 ¾"
finished size 2 ½" square

2 ½" Square Card

cut paper 4 ½" square
score all sides @ 2"
finished size 2 ¾" square

3" Square Card

cut paper 5" square
score all sides @ 2-3/8"

finished size 3 ¼" square

3 ½" Square Card

cut paper 6" square
score all sides @ 2 ¾"
finished size 3 ¾" square

4" Square Card

cut paper 7" square
score all sides @ 3 ¼"
finished size 4 ½" square

4 ½" Square Card

cut paper 8" square

score all sides @ 3-5/8"
finished size 5" square

5" Square Card

cut paper 8 ½" square
score all sides @ 3-7/8"
finished size 5 ½" square

6" Square Card

(or scrapbook page)
cut paper 10" square
score all sides @ 4-5/8"
finished size 6 ½" square

Framelit Envelopes for Labels Collection

(listed from largest to smallest)

1. Cut paper 8 ½" square
score @ 4-3/8" and 3-3/4"
finished size 5 ¼" x 6 ¼"

3. Cut paper 6 ½" square
score @ 3-1/4" and 2-7/8"
finished size 4 ½" x 4"

5. Cut paper 5" square
score @ 2 ¼" and 2"
finished size 3 ¼" x 3"

2. Cut paper 7 ½" square
score @ 3 ¾" and 3 ¼"
finished size 4 ½" x 5 ¼"

4. Cut paper 5 ½" square
score @ 2-3/8" and 2-3/4"
finished size 3 ¾" x 3 ¼"

6. Cut paper 3" square
score @ 1 ½" and 1 ¼"
finished size 2-1/8" x 1 ¾"

Framelit Envelopes for Hearts Collection

(listed from largest to smallest)

1. Cut paper 8 ½" square
score @ 3¾" and 4 ¼"
finished size 6 x 5 ¼"

3. Cut paper 6" square
score @ 3" and 2 ½"
finished size 3 ½" x 4 ¼"

5. Cut paper 4 ½" square
score @ 1 ½" and 1 ¾"
finished size 2-3/8" x 2 ¼"

2. Cut paper 7 ½" square
score @ 3 ½" and 3 ¼"
finished size 5" x 4 ½"

4. Cut paper 5" square
score @ 2 ¼" and 2"
finished size 3 ¼" x 3"

6. Use the Petal Card Double
Punch to make 1" square
envelope

To make your envelopes using the Diagonal Score Plate follow the steps below or
a free video tutorial can be found at www.jackietopa.com

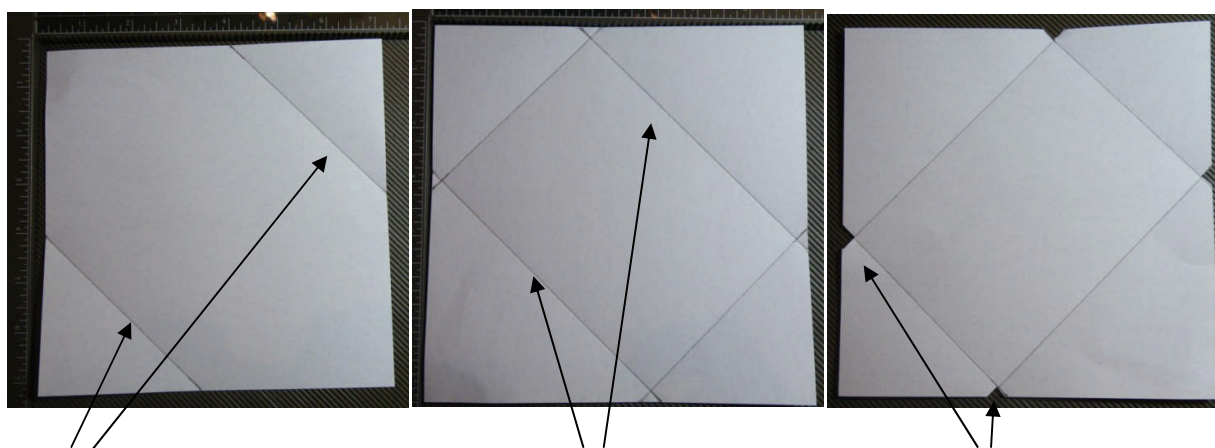

1. Score two opposite sides
2. Turn paper & score the other two sides
3. Nip the corners
4. Fold up your envelope starting with the sides and glue flaps in place.